

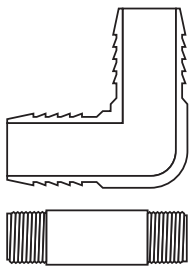

PVC (Polyvinyl Chloride) Schedule 40 is one of the most frequently specified thermoplastic materials due in large part to its ease of assembly and low cost.

Applications include but are not limited to potable water, chilled water, deionized water lines, irrigation, chemical processing, industrial plating and chemical drainage.

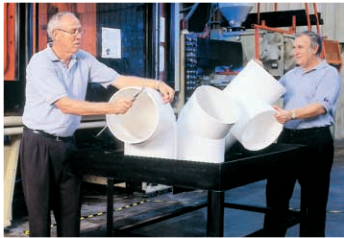

Colonial Engineering also offers PVC Insert Fittings for use with flexible polyethylene pipe and Threaded Pipe Nipples in PVC and CPVC. See our list price sheets for more information.

CUSTOMER SERVICE
Michigan (800) 374 0234
Florida (800) 432 6224
www.colonialengineering.com



TEE
All Soc

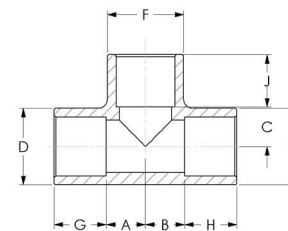

UNIV.#	PART#	SIZE	A	B	C	D	E	F	G	H	J
401-005	C06120	1/2	17/32	17/32	17/32	1-3/32	1-3/32	1-3/32	25/32	25/32	25/32
401-007	C09120	3/4	9/16	9/16	9/16	1-5/16	1-5/16	1-5/16	29/32	29/32	29/32
401-010	C11120	1	3/4	3/4	3/4	1-5/8	1-5/8	1-5/8	1	1	1
401-012	C13120	1-1/4	29/32	29/32	29/32	1-31/32	1-31/32	1-31/32	1-3/16	1-3/16	1-3/16
401-015	C16120	1-1/2	1-1/32	1-1/32	1-1/32	2-1/4	2-1/4	2-1/4	1-5/16	1-5/16	1-5/16
401-020	C21120	2	1-9/32	1-9/32	1-9/32	2-3/4	2-3/4	2-3/4	1-3/8	1-3/8	1-3/8
401-025	C26120	2-1/2	1-9/16	1-9/16	1-9/16	3-11/32	3-11/32	3-11/32	1-15/16	1-15/16	1-15/16
401-030	C31120	3	1-7/8	1-7/8	1-7/8	4	4	4	2-1/16	2-1/16	2-1/16
401-040	C41120	4	2-3/8	2-3/8	2-3/8	5-5/16	5-5/16	5-5/16	5-5/16	5-5/16	5-5/16
401-050	C51120	5	3-1/16	3-1/16	3-1/16	6-3/16	6-3/16	6-3/16	3-1/16	3-1/16	3-1/16
401-060	C61120	6	3-9/16	3-9/16	3-9/16	7-1/4	7-1/4	7-1/4	3-1/16	3-1/16	3-1/16
401-080	C81120	8	4-9/16	4-9/16	4-9/16	9-7/16	9-7/16	9-7/16	4	4	4
401-100	C111120	10	5-7/8	5-7/8	5-7/8	11-9/16	11-9/16	11-9/16	5-1/16	5-1/16	5-1/16
401-120	C121120	12	7	7	7	13-21/32	13-21/32	13-21/32	6-1/16	6-1/16	6-1/16

TEE
Soc x Soc x Reducing Soc

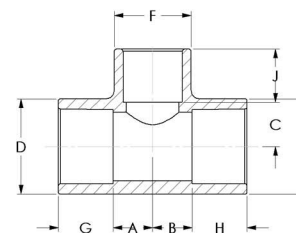

UNIV.#	PART#	SIZE	A	B	C	D	E	F	G	H	J
401-101	C09122	3/4 x 3/4 x 1/2	9/16	9/16	21/32	1-5/16	1-5/16	1-3/32	29/32	29/32	13/16
401-130	C11122	1 x 1 x 1/2	9/16	9/16	3/4	1-5/8	1-5/8	1-1/8	31/32	31/32	3/4
401-131	C11124	1 x 1 x 3/4	5/8	5/8	3/4	1-5/8	1-5/8	1-11/32	31/32	31/32	25/32
401-166	C13122	1-1/4 x 1-1/4 x 1/2	7/8	7/8	7/8	1-31/32	1-31/32	1-3/32	1-3/16	1-3/16	7/8
401-167	C13124	1-1/4 x 1-1/4 x 3/4	7/8	7/8	7/8	1-31/32	1-31/32	1-5/16	1-7/32	1-7/32	29/32
401-168	C13126	1-1/4 x 1-1/4 x 1	7/8	7/8	1	1-31/32	1-31/32	1-5/8	1-3/16	1-3/16	1
401-209	C16122	1-1/2 x 1-1/2 x 1/2	9/16	9/16	1-1/16	2-1/4	2-1/4	1-3/32	1-5/32	1-5/32	3/4
401-210	C16124	1-1/2 x 1-1/2 x 3/4	5/8	5/8	1-1/8	2-7/32	2-7/32	1-5/16	1-3/8	1-3/8	13/16
401-211	C16126	1-1/2 x 1-1/2 x 1	3/4	3/4	1-1/16	2-1/4	2-1/4	1-5/8	1-5/32	1-5/32	31/32
401-212	C16128	1-1/2 x 1-1/2 x 1-1/4	15/16	31/32	1-1/8	2-7/32	2-7/32	1-31/32	1-3/8	1-3/8	1-1/16
401-247	C21122	2 x 2 x 1/2	9/16	9/16	1-3/8	2-3/4	2-3/4	1-3/32	1-13/32	1-13/32	11/16
401-248	C21124	2 x 2 x 3/4	5/8	5/8	1-3/8	2-23/32	2-23/32	1-5/16	1-13/32	1-13/32	3/4
401-249	C21126	2 x 2 x 1	3/4	3/4	1-3/8	2-3/4	2-3/4	1-5/8	1-13/32	1-13/32	15/16
401-250	C21128	2 x 2 x 1-1/4	1-1/16	1-1/16	1-3/8	2-23/32	2-23/32	1-31/32	1-15/32	1-15/32	1-1/16
401-251	C21130	2 x 2 x 1-1/2	1-1/16	1-1/16	1-3/8	2-3/4	2-3/4	2-7/32	1-13/32	1-13/32	1-1/4
401-287	C26118	2-1/2 x 2-1/2 x 1/2	3/4	3/4	1-21/32	3-11/32	3-11/32	1-3/32	1-13/16	1-13/16	21/32
401-288	C26122	2-1/2 x 2-1/2 x 3/4	3/4	3/4	1-21/32	3-11/32	3-11/32	1-5/16	1-13/16	1-13/16	11/16
401-289	C26124	2-1/2 x 2-1/2 x 1	3/4	3/4	1-21/32	3-11/32	3-11/32	1-5/8	1-13/16	1-13/16	27/32
401-290	C26126	2-1/2 x 2-1/2 x 1-1/4	15/16	15/16	1-21/32	3-11/32	3-11/32	1-31/32	2	2	1-7/32
401-291	C26128	2-1/2 x 2-1/2 x 1-1/2	1-1/16	1-1/16	1-21/32	3-11/32	3-11/32	1-7/32	1-13/16	1-13/16	1-3/16
401-292	C26130	2-1/2 x 2-1/2 x 2	1-1/4	1-1/4	1-21/32	3-11/32	3-11/32	2-3/4	1-13/16	1-13/16	1-9/32
401-333	C31118	3 x 3 x 1/2	9/16	9/16	2	4	4	1-3/32	2	2	19/32
401-334	C31122	3 x 3 x 3/4	9/16	9/16	2	4	4	1-5/16	2	2	11/16
401-335	C31124	3 x 3 x 1	23/32	23/32	1-7/8	4	4	1-5/8	2	2	15/16
401-336	C31126	3 x 3 x 1-1/4	15/16	15/16	2	4	4	1-31/32	2	2	1

TEE

Soc x Soc x Red. Soc (continued)

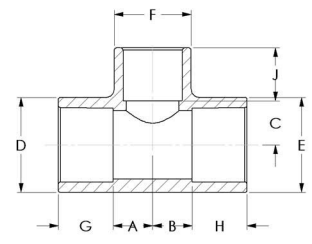

UNIV.#	PART#	SIZE	A	B	C	D	E	F	G	H	J
401-337	C31128	3 x 3 x 1-1/2	1-1/16	1-1/16	2	4	4	1-7/32	2	2	1-1/4
401-338	C31130	3 x 3 x 2	1-9/32	1-9/32	1-7/8	4	4	2-13/16	2	2	1-3/8
401-339	401-339	3 x 3 x 2-1/2	1-9/16	1-9/16	2-1/32	4	4	3-5/16	2	2	1-29/32
401-416	C41122	4 x 4 x 3/4	5/8	5/8	2-3/8	5-1/32	5-1/32	1-11/32	2-3/16	2-3/16	25/32
401-417	C41124	4 x 4 x 1	3/4	3/4	2-3/8	5-1/32	5-1/32	1-5/8	2-3/16	2-3/16	15/16
401-418	C41126	4 x 4 x 1-1/4	15/16	15/16	2-3/8	5-1/32	5-1/32	2	2-3/16	2-3/16	1-1/8
401-419	C41128	4 x 4 x 1-1/2	1-1/16	1-1/16	2-3/8	5-1/32	5-1/32	2-1/4	2-3/16	2-3/16	1-5/16
401-420	C41130	4 x 4 x 2	1-5/16	1-5/16	2-3/8	5-1/32	5-1/32	2-3/4	2-3/16	2-3/16	1-7/32
401-422	C41136	4 x 4 x 3	1-7/8	1-7/8	2-3/8	5-1/32	5-1/32	4	2-3/16	2-3/16	2-1/16
401-486	401-486	5 x 5 x 2	1-3/8	1-3/8	3-1/16	6-1/8	6-1/8	2-3/4	3	3	2
401-528	C61130	6 x 6 x 2	1-7/32	1-7/32	3-19/32	7-3/16	7-3/16	2-3/4	3-1/16	3-1/16	1-1/32
401-530	C61136	6 x 6 x 3	3-5/8	3-5/8	3-17/32	7-9/32	7-9/32	4	3-1/16	3-1/16	1-13/16
401-532	C61138	6 x 6 x 4	3-9/16	3-9/16	3-21/32	7-9/32	7-9/32	5	3-3/32	3-3/32	1-13/16
401-580	C81134	8 x 8 x 3	3-13/32	3-13/32	4-11/16	9-3/8	9-3/8	4	4-1/8	4-1/8	2-11/16
401-582	C81136	8 x 8 x 4	2-3/8	2-3/8	4-11/16	9-3/8	9-3/8	5	4-1/16	4-1/16	1-7/16
401-585	C81138	8 x 8 x 6	3-9/16	3-9/16	4-9/16	9-3/8	9-3/8	7-3/8	4-1/16	4-1/16	3-1/16

TEE

Soc x Reducing Soc x Soc

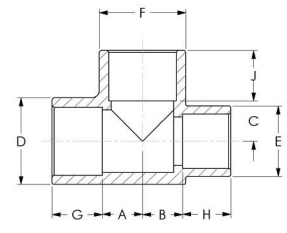

UNIV.#	PART#	SIZE	A	B	C	D	E	F	G	H	J
401-095	C09134	3/4 x 1/2 x 3/4	5/8	9/16	5/8	1-11/32	1-3/32	1-11/32	25/32	3/4	25/32
401-126	C11134	1 x 3/4 x 1	13/16	3/4	13/16	1-5/8	1-5/16	1-5/8	1-1/8	1	1-1/8

TEE

Soc x Reducing Soc x Reducing Soc

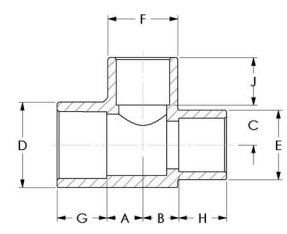

UNIV.#	PART#	SIZE	A	B	C	D	E	F	G	H	J
401-094	C09123	3/4 x 1/2 x 1/2	5/8	9/16	9/16	1-11/32	1-3/32	1-3/32	25/32	3/4	3/4
401-124	C11123	1 x 3/4 x 1/2	9/16	9/16	3/4	1-5/8	1-11/32	1-3/32	31/32	25/32	3/4
401-125	C11125	1 x 3/4 x 3/4	5/8	5/8	3/4	1-5/8	1-11/32	1-11/32	15/16	25/32	25/32
401-156	C13123	1-1/4 x 1 x 1/2	9/16	9/16	15/16	2	1-5/8	1-3/32	1-3/16	1-1/32	13/16
401-157	C13125	1-1/4 x 1 x 3/4	5/8	5/8	15/16	2	1-5/8	1-11/32	1-3/16	1-1/32	27/32
401-158	C13127	1-1/4 x 1 x 1	3/4	3/4	15/16	2	1-5/8	1-5/8	1-3/16	1-1/32	1-1/32
401-199	C16123	1-1/2 x 1-1/4 x 1/2	9/16	9/16	1-1/8	2-1/4	2	1-1/16	1-9/32	1-1/8	3/4
401-241	C21131	2 x 1-1/2 x 1-1/2	1-1/16	1-1/16	1-5/16	2-3/4	2-1/4	2-1/4	1-3/8	1-5/16	1-5/16



TEE

Soc x Soc x Increasing Soc

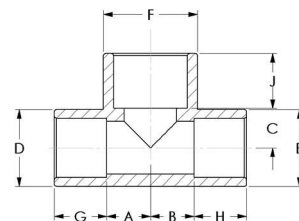

UNIV.#	PART#	SIZE	A	B	C	D	E	F	G	H	J
401-074	C09121	1/2 x 1/2 x 3/4	1/2	1/2	9/16	1-3/32	1-3/32	1-5/16	7/8	7/8	29/32
401-102	C11121	3/4 x 3/4 x 1	3/4	9/16	5/8	1-5/16	1-5/16	1-5/8	29/32	29/32	1-3/32
401-132	C13121	1 x 1 x 1-1/4	9/16	9/16	13/16	1-5/8	1-5/8	2	1-1/8	1-1/8	1-1/4
401-133	C11119	1 x 1 x 1-1/2	1-1/8	1-1/8	13/16	1-5/8	1-5/8	2-1/4	1-1/8	1-1/8	1-5/16
401-169	C16121	1-1/4 x 1-1/4 x 1-1/2	7/8	7/8	1	1-31/32	1-31/32	2-7/32	1-3/16	1-3/16	1-3/8
401-213	C21121	1-1/2 x 1-1/2 x 2	1	1	1-1/8	2-7/32	2-7/32	2-3/4	1-5/16	1-5/16	1-9/32

TEE

Soc x Soc x FPT

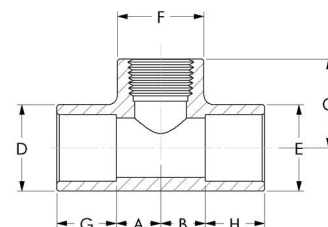

UNIV.#	PART#	SIZE	A	B	C	D	E	F	G	H	J
402-005	C06183	1/2	9/16	1/2	1-1/16	1-3/32	1-3/32	1-3/16	3/4	3/4	None
402-007	C09185	3/4	5/8	7/8	1-13/32	1-5/16	1-5/16	1-5/16	13/16	13/16	None
402-010	C11187	1	3/4	3/4	1-3/4	1-5/8	1-5/8	1-5/8	1-1/8	1-1/8	None
402-012	C13189	1-1/4	7/8	7/8	2-1/32	1-31/32	1-31/32	2	1-3/16	1-3/16	None
402-015	C16191	1-1/2	1-1/16	1-1/16	2-11/32	2-7/32	2-7/32	2-7/32	1-3/8	1-3/8	None
402-020	C21193	2	1-5/16	1-5/16	2-21/32	2-3/4	2-3/4	2-3/4	1-15/32	1-15/32	None
402-025	C26193	2-1/2	1-1/2	1-1/2	3-3/4	3-5/16	3-5/16	3-5/16	2-1/4	2-1/4	None
402-030	C31193	3	1-13/16	1-13/16	4-1/32	3-31/32	3-31/32	3-31/32	2-11/32	2-11/32	None
402-040	C41195	4	2-3/8	2-3/8	5	5-1/32	5-1/32	5-1/32	2-1/2	2-1/2	None

TEE

Soc x Soc x Increasing FPT

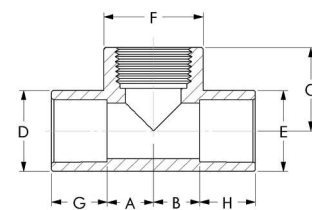

UNIV.#	PART#	SIZE	A	B	C	D	E	F	G	H	J
402-074	C09195	1/2 x 1/2 x 3/4	1/2	1/2	1-15/32	1-3/32	1-3/32	1-5/16	7/8	7/8	None



TEE

Soc x Reducing Soc x Reducing FPT

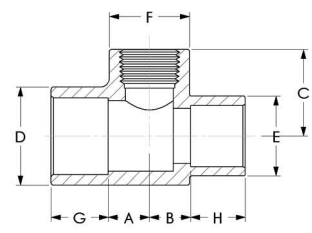

UNIV.#	PART#	SIZE	A	B	C	D	E	F	G	H	J
402-094	C09184	3/4 x 1/2 x 1/2	1/2	21/32	1-5/16	1-5/16	1-3/32	1-3/16	13/16	7/8	None
402-095	C09186	3/4 x 1/2 x 3/4	9/16	5/8	1-15/32	1-5/16	1-3/32	1-5/16	29/32	7/8	None
402-124	C11184	1 x 3/4 x 1/2	17/32	17/32	1-9/16	1-5/8	1-5/16	1-1/16	1-5/32	1-1/32	None
402-125	C11186	1 x 3/4 x 3/4	17/32	17/32	1-1/2	1-5/8	1-5/16	1-5/16	1-5/32	1-7/32	None
402-199	C16184	1-1/2 x 1-1/4 x 1/2	17/32	17/32	1-7/8	2-1/4	2	1-1/16	1-5/16	1-3/8	None

TEE

Soc x Soc x Reducing FPT

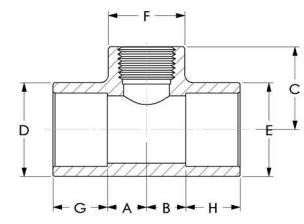

UNIV.#	PART#	SIZE	A	B	C	D	E	F	G	H	J
402-071	C06122	1/2 x 1/2 x 1/8	5/16	5/16	29/32	1-3/32	1-3/32	5/8	3/4	3/4	None
402-101	C09183	3/4 x 3/4 x 1/2	9/16	9/16	1-1/4	1-5/16	1-5/16	1-3/16	25/32	25/32	None
402-130	C11183	1 x 1 x 1/2	11/16	11/16	1-9/16	1-11/32	1-11/32	1-1/16	13/32	13/32	None
402-131	C11185	1 x 1 x 3/4	19/32	19/32	1-17/32	1-5/8	1-5/8	1-5/16	1-1/32	1-1/32	None
402-166	C13183	1-1/4 x 1-1/4 x 1/2	7/8	7/8	1-3/4	1-31/32	1-31/32	1-3/16	1-3/16	1-3/16	None
402-167	C13185	1-1/4 x 1-1/4 x 3/4	7/8	7/8	1-25/32	1-31/32	1-31/32	1-5/16	1-3/16	1-3/16	None
402-168	C13187	1-1/4 x 1-1/4 x 1	7/8	7/8	1-31/32	1-31/32	1-31/32	1-1/16	1-3/16	1-3/16	None
402-209	C16183	1-1/2 x 1-1/2 x 1/2	9/16	9/16	1-13/16	2-1/4	2-1/4	1-3/16	1-5/16	1-5/16	None
402-210	C16185	1-1/2 x 1-1/2 x 3/4	31/32	31/32	1-29/32	2-7/32	2-7/32	1-5/16	1-13/32	1-13/32	None
402-211	C16187	1-1/2 x 1-1/2 x 1	3/4	3/4	2-1/32	2-1/4	2-1/4	1-1/16	1-5/16	1-5/16	None
402-212	C16189	1-1/2 x 1-1/2 x 1-1/4	1	1	2-5/32	2-7/32	2-7/32	1-31/32	1-3/8	1-3/8	None
402-247	C21183	2 x 2 x 1/2	5/8	5/8	2-1/16	2-3/4	2-3/4	1-3/16	1-13/32	1-13/32	None
402-248	C21185	2 x 2 x 3/4	5/8	5/8	2-3/32	2-3/4	2-3/4	1-5/16	1-13/32	1-13/32	None
402-249	C21187	2 x 2 x 1	3/4	3/4	2-1/4	2-3/4	2-3/4	1-1/16	1-13/32	1-13/32	None
402-250	C21189	2 x 2 x 1-1/4	1-1/4	1-1/4	2-13/32	2-23/32	2-23/32	1-31/32	1-15/32	1-15/32	None
402-251	C21191	2 x 2 x 1-1/2	1-1/16	1-1/16	2-9/16	2-3/4	2-3/4	2-7/32	1-13/32	1-13/32	None
402-287	C26181	2-1/2 x 2-1/2 x 1/2	17/32	17/32	2-11/32	3-11/32	3-11/32	1-3/16	1-15/16	1-15/16	None
402-288	C26183	2-1/2 x 2-1/2 x 3/4	5/8	5/8	2-3/8	3-11/32	3-11/32	1-5/16	1-15/16	1-15/16	None
402-289	C26185	2-1/2 x 2-1/2 x 1	3/4	3/4	2-17/32	3-11/32	3-11/32	1-1/16	1-15/16	1-15/16	None
402-291	C26189	2-1/2 x 2-1/2 x 1-1/2	1-1/8	1-1/8	2-5/8	3-5/16	3-5/16	2-7/32	2	2	None
402-333	C31181	3 x 3 x 1/2	1/2	1/2	2-5/8	4	4	1-3/32	2	2	None
402-334	C31183	3 x 3 x 3/4	9/16	9/16	2-5/8	4	4	1-5/16	2	2	None
402-335	C31185	3 x 3 x 1	11/16	11/16	2-13/16	4-1/32	4-1/32	1-1/16	2	2	None
402-337	C31189	3 x 3 x 1-1/2	1-1/16	1-1/16	3-5/32	4	4	2-7/32	2	2	None
402-338	C31191	3 x 3 x 2	1-9/32	1-9/32	3-5/32	4	4	2-23/32	2	2	None
402-416	C41183	4 x 4 x 3/4	2-5/16	2-5/16	3-9/32	5-1/32	5-1/32	1-5/16	2-1/2	2-1/2	None
402-417	C41185	4 x 4 x 1	1	1	3-5/16	5	5	1-1/16	2-7/32	2-7/32	None
402-532	C61195	6 x 6 x 4	3-9/16	3-9/16	5-27/32	7-1/4	7-1/4	5	3-7/32	3-7/32	None
402-582	C81195	8 x 8 x 4	2-3/8	2-3/8	5-15/16	9-3/8	9-3/8	5-1/8	4-1/16	4-1/16	None



TEE
All FPT

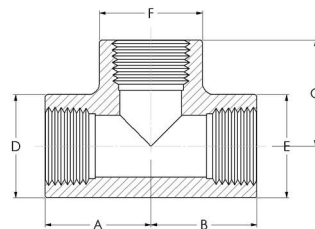

UNIV.#	PART#	SIZE	A	B	C	D	E	F	G	H	J
405-005	C06132	1/2	1-3/8	1-3/8	1-3/8	1-3/16	1-3/16	1-3/16	None	None	None
405-007	C09132	3/4	1-15/32	1-15/32	1-15/32	1-5/16	1-5/16	1-5/16	None	None	None
405-010	C11132	1	1-11/16	1-11/16	1-11/16	1-5/8	1-5/8	1-5/8	None	None	None
405-012	C13132	1-1/4	1-15/16	1-15/16	1-15/16	2-1/4	2-1/4	2-1/4	None	None	None
405-015	C16132	1-1/2	2-3/8	2-3/8	2-3/8	2-7/32	2-7/32	2-7/32	None	None	None
405-020	C21132	2	2-23/32	2-23/32	2-19/32	2-23/32	2-23/32	2-23/32	None	None	None
405-025	C26132	2-1/2	3-23/32	3-23/32	3-23/32	3-5/16	3-5/16	3-5/16	None	None	None
405-030	C31132	3	4-3/16	4-3/16	4-3/16	3-31/32	3-31/32	3-31/32	None	None	None
405-040	C41132	4	4-13/16	4-13/16	4-13/16	5	5	5	None	None	None

90° ELBOW
Soc x Soc

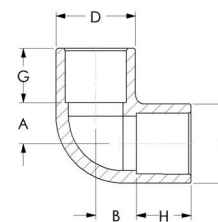

UNIV.#	PART#	SIZE	A	B	C	D	E	F	G	H	J
406-005	C06100	1/2	1/2	1/2	None	1-3/32	1-3/32	None	3/4	3/4	None
406-007	C09100	3/4	9/16	9/16	None	1-5/16	1-5/16	None	7/8	7/8	None
406-010	C11100	1	23/32	23/32	None	1-5/8	1-5/8	None	1	1	None
406-012	C13100	1-1/4	7/8	7/8	None	2	2	None	1-1/8	1-1/8	None
406-015	C16100	1-1/2	1	1	None	2-7/32	2-7/32	None	1-3/16	1-3/16	None
406-020	C21100	2	1-7/32	1-7/32	None	2-23/32	2-23/32	None	1-3/8	1-3/8	None
406-025	C26100	2-1/2	1-17/32	1-17/32	None	3-5/16	3-5/16	None	1-15/16	1-15/16	None
406-030	C31100	3	1-27/32	1-27/32	None	4	4	None	2-1/16	2-1/16	None
406-040	C41100	4	2-5/16	2-5/16	None	5-1/16	5-1/16	None	2-1/16	2-1/16	None
406-050	C51100	5	3-1/16	3-1/16	None	6-5/32	6-5/32	None	3-1/16	3-1/16	None
406-060	C61100	6	3-1/16	3-1/16	None	7-1/4	7-1/4	None	3-9/16	3-9/16	None
406-080	C81100	8	4-17/32	4-17/32	None	9-11/32	9-11/32	None	4-1/32	4-1/32	None
406-100	C111100	10	5-7/8	5-7/8	None	11-9/16	11-9/16	None	5-1/16	5-1/16	None
406-120	C121100	12	7	7	None	13-21/32	13-21/32	None	6-1/16	6-1/16	None

90° REDUCING ELBOW

Soc x Reducing Soc

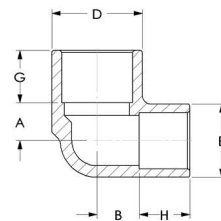

UNIV.#	PART#	SIZE	A	B	C	D	E	F	G	H	J
406-101	C09170	3/4 x 1/2	9/16	5/8	None	1-11/32	1-3/32	None	25/32	3/4	None
406-130	C11170	1 x 1/2	9/16	3/4	None	1-5/8	1-3/32	None	31/32	3/4	None
406-131	C11172	1 x 3/4	5/8	3/4	None	1-5/8	1-11/32	None	31/32	25/32	None
406-168	C13170	1-1/4 x 1	7/8	1-5/32	None	1-31/32	1-5/8	None	1-3/16	1-1/8	None
406-212	C16170	1-1/2 x 1-1/4	13/16	1-1/2	None	2-7/32	1-31/32	None	1-3/8	1-3/16	None
406-251	C21170	2 x 1-1/2	1-1/4	1-19/32	None	2-23/32	2-7/32	None	1-15/32	1-13/32	None

90° ELBOW

Soc x FPT

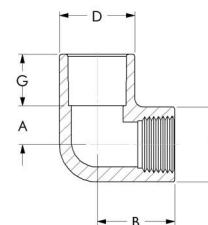

UNIV.#	PART#	SIZE	A	B	C	D	E	F	G	H	J
407-005	C06106	1/2	1/4	1-1/16	None	1-3/32	1-3/32	None	13/16	None	None
407-007	C09107	3/4	19/32	1-13/32	None	1-5/16	1-5/16	None	13/16	None	None
407-010	C11108	1	13/16	1-11/16	None	1-5/8	1-5/8	None	15/16	None	None
407-012	C13107	1-1/4	1-1/16	2-1/16	None	2	2	None	1	None	None
407-015	C16107	1-1/2	31/32	2-3/8	None	2-7/32	2-7/32	None	1-13/32	None	None
407-020	C21107	2	1-3/4	2-23/32	None	2-23/32	2-23/32	None	31/32	None	None
407-025	C26106	2-1/2	1-1/2	3-23/32	None	3-5/16	3-5/16	None	2-7/32	None	None
407-030	C31106	3	1-25/32	4-3/16	None	3-31/32	3-31/32	None	2-11/32	None	None
407-040	C41106	4	2-5/16	4-13/16	None	5-1/32	5-1/32	None	2-1/2	None	None

90° REDUCING ELBOW

Soc x FPT

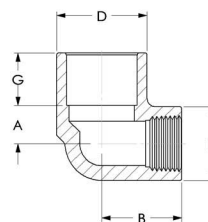

UNIV.#	PART#	SIZE	A	B	C	D	E	F	G	H	J
407-074	C06107	1/2x3/4	1/2	1-13/32	None	1-1/16	1-5/16	None	13/16	None	None
407-101	C09106	3/4 x 1/2	1/2	1-11/32	None	1-5/16	1-1/32	None	3/4	None	None
407-130	C11106	1 x 1/2	3/4	1-1/2	None	1-5/8	1-1/32	None	11/16	None	None
407-131	C11107	1 x 3/4	13/16	1-25/32	None	1-5/8	1-5/16	None	21/32	None	None
407-168	C13106	1-1/4 x 1	1-1/32	2-1/16	None	1-31/32	1-5/8	None	25/32	None	None
407-212	C16106	1-1/2 x 1-1/4	7/8	2-3/8	None	2-7/32	1-31/32	None	1-7/32	None	None
407-251	C21106	2 x 1-1/2	1-3/8	2-23/32	None	2-23/32	2-7/32	None	1	None	None



90° ELBOW
FPT x FPT

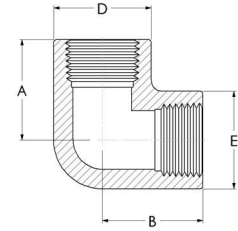

UNIV.#	PART#	SIZE	A	B	C	D	E	F	G	H	J
408-005	C06102	1/2	1-3/16	1-3/16	None	1-3/32	1-3/32	None	None	None	None
408-007	C09102	3/4	1-15/32	1-15/32	None	1-5/16	1-5/16	None	None	None	None
408-010	C11102	1	1-13/16	1-13/16	None	1-5/8	1-5/8	None	None	None	None
408-012	C13102	1-1/4	2-1/16	2-1/16	None	1-31/32	1-31/32	None	None	None	None
408-015	C16102	1-1/2	2-3/8	2-3/8	None	2-7/32	2-7/32	None	None	None	None
408-020	C21102	2	2-23/32	2-23/32	None	2-23/32	2-23/32	None	None	None	None

90° STREET ELBOW
Soc x Spigot

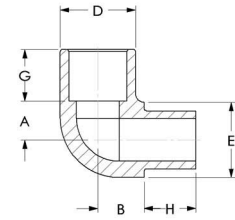

UNIV.#	PART#	SIZE	A	B	C	D	E	F	G	H	J
409-005	C06101	1/2	17/32	19/32	None	1-3/32	1-3/32	None	3/4	3/4	None
409-007	C09101	3/4	11/16	51/64	None	1-1/16	1-5/16	None	13/16	13/16	None
409-010	C11101	1	11/16	27/32	None	1-5/8	1-13/32	None	15/16	1	None
409-012	C13101	1-1/4	15/16	1-3/32	None	2	2	None	1-1/32	1-1/32	None
409-015	C16101	1-1/2	1-7/32	1-3/32	None	1-29/32	2-7/32	None	1-1/4	1-7/32	None
409-020	C21101	2	1-7/16	1-3/8	None	2-13/32	2-23/32	None	1-9/32	1-9/32	None

90° ELBOW
Soc x MPT

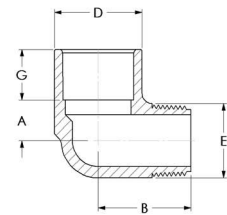

UNIV.#	PART#	SIZE	A	B	C	D	E	F	G	H	J
410-005	C06105	1/2	9/16	1-15/32	None	1-1/8	1-1/8	None	3/4	None	None
410-007	C09105	3/4	5/8	1-17/32	None	1-11/32	1-11/32	None	25/32	None	None
410-010	C11105	1	31/32	2-1/8	None	1-9/32	1-21/32	None	7/8	None	None
410-012	C13105	1-1/4	1-5/32	2-1/2	None	1-21/32	2-1/32	None	1	None	None
410-015	C16105	1-1/2	1-1/4	2-25/32	None	1-7/8	2-9/32	None	27/32	None	None
410-020	C21105	2	1-15/32	3-1/8	None	2-11/32	2-25/32	None	29/32	None	None
410-101	C09104	3/4 x 1/2	9/16	1-1/2	None	1-1/8	None	None	3/4	None	None

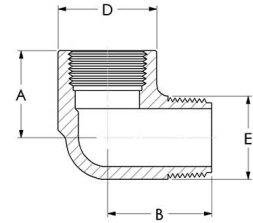
90° ELBOW
 FPT x MPT

UNIV.#	PART#	SIZE	A	B	C	D	E	F	G	H	J
412-005	C06103	1/2	1	1-11/32	None	27/32	1-1/8	None	None	None	None
412-007	C09103	3/4	1-17/32	1-25/32	None	1-1/32	1-11/32	None	None	None	None
412-010	C11103	1	2	2-1/8	None	1-5/16	1-21/32	None	None	None	None
412-012	C13103	1-1/4	2-5/16	2-13/32	None	1-5/8	2-1/32	None	None	None	None
412-015	C16103	1-1/2	2-7/16	2-13/16	None	1-7/8	2-9/32	None	None	None	None
412-020	C21103	2	2-7/8	3-3/32	None	2-11/32	2-3/4	None	None	None	None

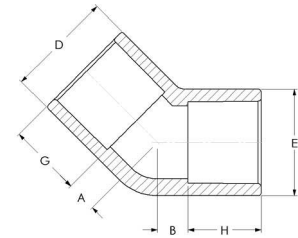
45° ELBOW
 Soc x Soc

UNIV.#	PART#	SIZE	A	B	C	D	E	F	G	H	J
417-005	C06110	1/2	1/4	1/4	None	1-1/8	1-1/8	None	3/4	3/4	None
417-007	C09110	3/4	11/32	11/32	None	1-5/16	1-5/16	None	13/16	13/16	None
417-010	C11110	1	3/8	3/8	None	1-5/8	1-5/8	None	1-1/8	1-1/8	None
417-012	C13110	1-1/4	3/8	3/8	None	2	2	None	1-1/16	1-1/16	None
417-015	C16110	1-1/2	1/2	1/2	None	2-7/32	2-7/32	None	1-5/16	1-5/16	None
417-020	C21110	2	11/16	11/16	None	2-3/4	2-3/4	None	1-3/8	1-3/8	None
417-025	C26110	2-1/2	11/16	11/16	None	3-11/32	3-11/32	None	1-29/32	1-29/32	None
417-030	C31110	3	27/32	27/32	None	3-31/32	3-31/32	None	2	2	None
417-040	C41110	4	1	1	None	5	5	None	2-1/8	2-1/8	None
417-050	C51110	5	1-15/32	1-15/32	None	6-1/8	6-1/8	None	3-1/16	3-1/16	None
417-060	C61110	6	2-1/8	2-1/8	None	7-7/32	7-7/32	None	3-1/16	3-1/16	None
417-080	C81110	8	2-11/32	2-11/32	None	9-13/32	9-13/32	None	4-3/32	4-3/32	None
417-100	C111110	10	2-7/8	2-7/8	None	11-9/16	1-9/16	None	5-3/32	5-3/32	None
417-120	C121110	12	3-7/16	3-7/16	None	13-13/32	13-13/32	None	6-1/16	6-1/16	None



CROSS
All Soc

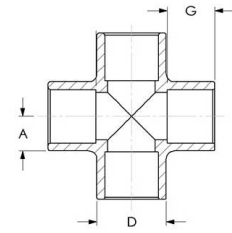

UNIV.#	PART#	SIZE	A	B	C	D	E	F	G	H	J
420-005	C06245	1/2	1/2	None	None	1-3/32	None	None	3/4	None	None
420-007	C09245	3/4	9/16	None	None	1-5/16	None	None	13/16	None	None
420-010	C11245	1	23/32	None	None	1-5/8	None	None	1	None	None
420-012	C13245	1-1/4	15/16	None	None	2	None	None	1-1/8	None	None
420-015	C16245	1-1/2	1-1/16	None	None	2-1/4	None	None	1-5/16	None	None
420-020	C21245	2	1-5/16	None	None	2-3/4	None	None	1-3/8	None	None
420-030	C31245	3	1-15/16	None	None	4	None	None	2	None	None
420-040	C41245	4	2-1/2	None	None	5	None	None	2	None	None

COUPLING
Soc x Soc

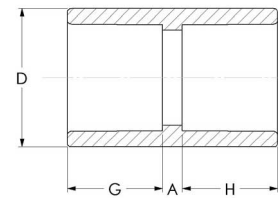

UNIV.#	PART#	SIZE	A	B	C	D	E	F	G	H	J
429-005	C06140	1/2	1/8	None	None	1-3/32	None	None	3/4	3/4	None
429-007	C09140	3/4	1/8	None	None	1-11/32	None	None	7/8	7/8	None
429-010	C11140	1	1/8	None	None	1-5/8	None	None	1-3/32	1-3/32	None
429-012	C13140	1-1/4	1/8	None	None	2	None	None	1-1/8	1-1/8	None
429-015	C16140	1-1/2	1/8	None	None	2-1/4	None	None	1-5/16	1-5/16	None
429-020	C21140	2	1/8	None	None	2-23/32	None	None	1-13/32	1-13/32	None
429-025	C26140	2-1/2	3/16	None	None	3-5/16	None	None	2-3/16	2-3/16	None
429-030	C31140	3	7/32	None	None	4	None	None	2-1/16	2-1/16	None
429-040	C41140	4	7/32	None	None	5	None	None	2-7/32	2-7/32	None
429-050	C51140	5	7/32	None	None	6-1/8	None	None	3-1/16	3-1/16	None
429-060	C61140	6	1/4	None	None	7-3/8	None	None	3-1/32	3-1/32	None
429-080	C81140	8	5/16	None	None	9-11/32	None	None	4-1/32	4-1/32	None
429-100	C111140	10	11/32	None	None	11-19/32	None	None	6-1/4	6-1/4	None
429-120	C121140	12	5/16	None	None	13-1/2	None	None	6-9/32	6-9/32	None

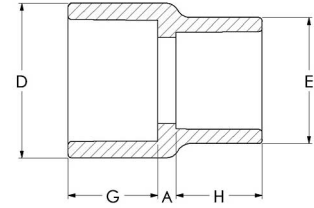
COUPLING-REDUCING
 Soc x Reducing Soc

UNIV.#	PART#	SIZE	A	B	C	D	E	F	G	H	J
429-101	C09148	3/4 x 1/2	3/16	None	None	1-5/16	1-1/16	None	25/32	3/4	None
429-131	C11148	1 x 3/4	3/16	None	None	1-5/8	1-5/16	None	15/16	25/32	None
429-168	C13148	1-1/4 x 1	3/16	None	None	1-31/32	1-5/8	None	1-3/16	1-1/32	None
429-251	429-251	2x1-1/2	9/32	None	None	2-27/32	2-11/32	None	1-1/2	1-13/32	None
429-338	429-338	3x2	5/16	None	None	4	2-23/32	None	2-1/16	1-3/8	None
429-422	429-422	4x3	3/16	None	None	5-3/16	4-5/32	None	2-5/16	1-3/16	None

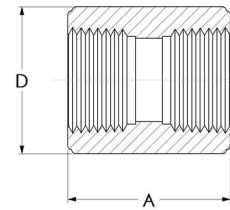
COUPLING
 FPT x FPT

UNIV.#	PART#	SIZE	A	B	C	D	E	F	G	H	J
430-005	C06141	1/2	1-5/8	None	None	1-1/16	None	None	None	None	None
430-007	C09141	3/4	1-21/32	None	None	1-5/16	None	None	None	None	None
430-010	C11141	1	2-5/16	None	None	1-5/8	None	None	None	None	None
430-012	C13141	1-1/4	2-7/16	None	None	1-31/32	None	None	None	None	None
430-015	C16141	1-1/2	2-7/8	None	None	2-7/32	None	None	None	None	None
430-020	C21141	2	2-17/32	None	None	2-23/32	None	None	None	None	None
430-025	C26141	2-1/2	3-27/32	None	None	3-11/32	None	None	None	None	None
430-030	C31141	3	3-27/32	None	None	3-31/32	None	None	None	None	None
430-040	C41141	4	4-3/16	None	None	5-1/32	None	None	None	None	None

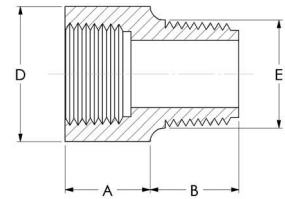
RISER EXTENDER
 FPT x MPT

UNIV.#	PART#	SIZE	A	B	C	D	E	F	G	H	J
434-005	C06225	1/2	2-1/32	5/8	None	1-1/8	13/16	None	None	None	None
434-007	C09225	3/4	1-31/32	11/16	None	1-11/32	1-1/32	None	None	None	None



FEMALE ADAPTER

Soc x FPT

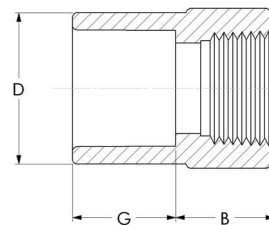

UNIV.#	PART#	SIZE	A	B	C	D	E	F	G	H	J
435-005	C06151	1/2	None	29/32	None	1-1/8	None	None	23/32	None	None
435-007	C09151	3/4	None	13/16	None	1-11/32	None	None	25/32	None	None
435-010	C11151	1	None	15/16	None	1-19/32	None	None	1	None	None
435-012	C13151	1-1/4	None	1-1/8	None	2	None	None	1-1/8	None	None
435-015	C16151	1-1/2	None	1-1/8	None	2-1/4	None	None	1-5/16	None	None
435-020	C21151	2	None	1-5/32	None	2-3/4	None	None	1-3/8	None	None
435-025	C26151	2-1/2	None	2-3/8	None	3-11/32	None	None	2-3/16	None	None
435-030	C31151	3	None	1-27/32	None	4	None	None	2	None	None
435-040	C41151	4	None	1-15/16	None	5-1/32	None	None	2-7/32	None	None
435-050	C51151	5	None	1-3/4	None	6-1/8	None	None	3-1/32	None	None
435-060	C61151	6	None	1-13/16	None	7-7/32	None	None	3-1/16	None	None
435-080	C81151	8	None	2-11/32	None	9-11/32	None	None	4-1/32	None	None

ADAPTER

FPT x Reducing Soc

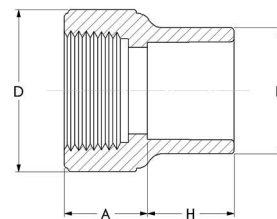

UNIV.#	PART#	SIZE	A	B	C	D	E	F	G	H	J
435-074	C09160	3/4 x 1/2	1	None	None	1-1/4	1-1/8	None	None	3/4	None
435-102	C11160	1 x 3/4	1-1/8	None	None	1-17/32	1-11/32	None	None	25/32	None
435-132	C13160	1-1/4 x 1	1-5/16	None	None	1-31/32	1-5/8	None	None	1	None

REDUCING FEMALE ADAPTER

Soc x Reducing FPT

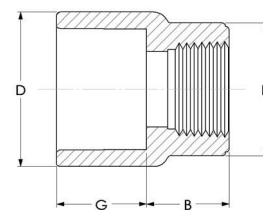

UNIV.#	PART#	SIZE	A	B	C	D	E	F	G	H	J
435-101	C09161	3/4 x 1/2	None	1-1/8	None	1-11/32	1-1/16	None	13/16	None	None
435-130	C11162	1 x 1/2	None	1-1/4	None	1-5/8	1-1/32	None	31/32	None	None
435-131	C11161	1 x 3/4	None	1-1/8	None	1-5/8	1-1/4	None	31/32	None	None
435-168	C13161	1-1/4 x 1	None	1-3/16	None	1-31/32	1-5/8	None	1-1/4	None	None

REDUCING MALE ADAPTER

Soc x Reducing MPT

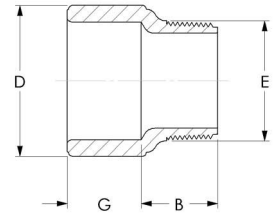

UNIV.#	PART#	SIZE	A	B	C	D	E	F	G	H	J
436-074	C09165	3/4 x 1/2	None	1-1/16	None	1-5/16	13/16	None	13/16	None	None
436-102	C11165	1 x 3/4	None	1-7/32	None	1-5/8	1-1/32	None	1	None	None
436-132	C13165	1-1/4 x 1	None	1-7/16	None	1-31/32	1-9/32	None	1-1/8	None	None
436-169	C16165	1-1/2 x 1-1/4	None	1-3/8	None	2-7/32	1-5/8	None	1-5/16	None	None
436-213	C21165	2 x 1-1/2	None	1-7/16	None	2-23/32	1-7/8	None	1-3/8	None	None

ADAPTER

MPT x Reducing Soc

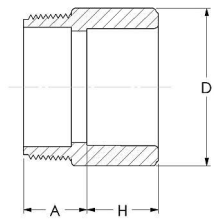

UNIV.#	PART#	SIZE	A	B	C	D	E	F	G	H	J
436-101	C09166	3/4 x 1/2	23/32	None	None	1-1/16	None	None	None	7/8	None
436-131	C11166	1 x 3/4	25/32	None	None	1-5/16	None	None	None	1	None
436-168	C13166	1-1/4 x 1	7/8	None	None	1-5/8	None	None	None	31/32	None
436-212	C16166	1-1/2 x 1-1/4	1-7/32	None	None	2-7/32	None	None	None	1-11/32	None
436-251	C21166	2 x 1-1/2	1-7/32	None	None	2-7/32	None	None	None	1-5/16	None

MALE ADAPTER

Soc x MPT

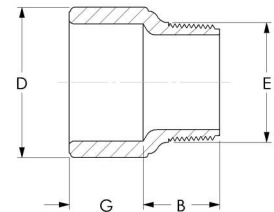

UNIV.#	PART#	SIZE	A	B	C	D	E	F	G	H	J
436-005	C06150	1/2	None	1	None	1-1/8	27/32	None	3/4	None	None
436-007	C09150	3/4	None	1-1/16	None	1-11/32	1-1/16	None	25/32	None	None
436-010	C11150	1	None	1-5/32	None	1-11/16	1-11/32	None	15/16	None	None
436-012	C13150	1-1/4	None	1-11/32	None	1-31/32	1-5/8	None	1-5/32	None	None
436-015	C16150	1-1/2	None	1-3/8	None	2-7/32	1-7/8	None	1-5/16	None	None
436-020	C21150	2	None	1-17/32	None	2-23/32	2-3/4	None	1-13/32	None	None
436-025	C26150	2-1/2	None	1-13/16	None	3-11/32	2-27/32	None	1-15/16	None	None
436-030	C31150	3	None	1-29/32	None	4	3-1/2	None	2-1/16	None	None
436-040	C41150	4	None	2	None	5-1/32	4-1/2	None	2-3/16	None	None
436-050	C51150	5	None	2-9/32	None	6-1/4	5-11/16	None	3-1/16	None	None
436-060	C61150	6	None	2-7/16	None	7-1/4	6-21/32	None	3-1/16	None	None
436-080	C81150	8	None	2-1/2	None	9-11/32	8-1/2	None	4-1/2	None	None

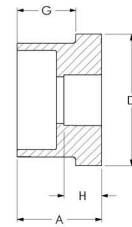

REDUCING BUSHING
Spigot x Reducing Soc

UNIV.#	PART#	SIZE	A	B	C	D	E	F	G	H	J
437-101	C09234	3/4 x 1/2	1-1/16	None	None	1-1/8	None	None	27/32	3/4	None
437-130	C11232	1 x 1/2	1-9/32	None	None	1-3/8	None	None	1-1/16	3/4	None
437-131	C11234	1 x 3/4	1-9/32	None	None	1-3/8	None	None	1-1/16	13/16	None
437-166	C13230	1-1/4 x 1/2	1-15/32	None	None	1-3/4	None	None	1-1/4	3/4	None
437-167	C13232	1-1/4 x 3/4	1-1/2	None	None	1-3/4	None	None	1-1/4	19/32	None
437-168	C13234	1-1/4 x 1	1-1/2	None	None	1-3/4	None	None	1-1/4	1	None
437-209	C16230	1-1/2 x 1/2	1-11/16	None	None	2	None	None	1-3/8	3/4	None
437-210	C16232	1-1/2 x 3/4	1-11/16	None	None	2	None	None	1-3/8	13/16	None
437-211	C16234	1-1/2 x 1	1-11/16	None	None	2	None	None	1-3/8	1	None
437-212	C16236	1-1/2 x 1-1/4	1-11/16	None	None	2	None	None	1-3/8	1-3/16	None
437-247	C21230	2 x 1/2	1-13/16	None	None	2-7/16	None	None	1-1/2	3/4	None
437-248	C21232	2 x 3/4	1-3/4	None	None	2-7/16	None	None	1-7/16	13/16	None
437-249	C21234	2 x 1	1-25/32	None	None	2-7/16	None	None	1-15/32	1	None
437-250	C21236	2 x 1-1/4	1-25/32	None	None	2-7/16	None	None	1-15/32	1-1/8	None
437-251	C21238	2 x 1-1/2	1-13/16	None	None	2-7/16	None	None	1-1/2	1-5/16	None
437-289	C26230	2-1/2 x 1	2-7/32	None	None	2-31/32	None	None	1-15/16	31/32	None
437-290	C26232	2-1/2 x 1-1/4	2-7/32	None	None	2-31/32	None	None	1-15/16	1-1/8	None
437-291	C26234	2-1/2 x 1-1/2	2-7/32	None	None	2-31/32	None	None	1-15/16	1-5/16	None
437-292	C26236	2-1/2 x 2	2-7/32	None	None	2-31/32	None	None	1-15/16	1-3/8	None
437-334	C31230	3 x 3/4	2-11/32	None	None	3-17/32	None	None	2-1/16	25/32	None
437-335	C31232	3 x 1	2-11/32	None	None	3-17/32	None	None	2-1/16	31/32	None
437-336	C31234	3 x 1-1/4	2-11/32	None	None	3-17/32	None	None	2-1/16	1-1/8	None
437-337	C31236	3 x 1-1/2	2-11/32	None	None	3-17/32	None	None	2-1/16	1-5/16	None
437-338	C31238	3 x 2	2-11/32	None	None	3-17/32	None	None	2-1/16	1-3/8	None
437-339	C31240	3 x 2-1/2	2-11/32	None	None	3-17/32	None	None	2-1/16	1-15/16	None
437-417	C41230	4 x 1	2-1/2	None	None	4-17/32	None	None	2-7/32	31/32	None
437-418	C41232	4 x 1-1/4	2-1/2	None	None	4-17/32	None	None	2-7/32	1-1/8	None
437-419	C41234	4 x 1-1/2	2-1/2	None	None	4-17/32	None	None	2-7/32	1-5/16	None
437-420	C41236	4 x 2	2-1/2	None	None	4-17/32	None	None	2-7/32	1-3/8	None
437-421	C41238	4 x 2-1/2	2-1/2	None	None	4-17/32	None	None	2-7/32	1-15/16	None
437-422	C41240	4 x 3	2-1/2	None	None	4-17/32	None	None	2-7/32	2-1/16	None
437-490	C51230	5 x 4	3-7/16	None	None	6-13/32	None	None	3-1/32	2-9/32	None
437-530	C61228	6 x 3	3-15/32	None	None	6-3/4	None	None	3-1/16	2-1/16	None
437-532	C61230	6 x 4	3-15/32	None	None	6-3/4	None	None	3-1/16	2-5/16	None
437-534	C61232	6 x 5	3-15/32	None	None	6-11/16	None	None	3-1/32	3-1/32	None
437-585	C81232	8 x 6	4-9/16	None	None	8-25/32	None	None	4-1/16	3-1/32	None
437-626	C111228	10 x 6	6-7/16	None	None	11-1/4	None	None	5-1/16	3-1/2	None
437-628	C111230	10 x 8	5-1/2	None	None	11-1/4	None	None	5-1/16	4-1/16	None
437-670	C121230	12 x 10	6-29/32	None	None	13-1/4	None	None	6-15/32	5-29/32	None

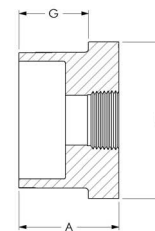
REDUCING BUSHING
 Spigot x Reducing FPT

UNIV.#	PART#	SIZE	A	B	C	D	E	F	G	H	J
438-071	C06229	1/2 x 1/8	31/32	None	None	15/16	None	None	3/4	None	None
438-072	C06231	1/2 x 1/4	31/32	None	None	15/16	None	None	3/4	None	None
438-101	C09235	3/4 x 1/2	1-1/32	None	None	1-1/8	None	None	13/16	None	None
438-130	C11233	1 x 1/2	1-1/4	None	None	1-3/8	None	None	1	None	None
438-131	C11235	1 x 3/4	1-1/4	None	None	1-3/8	None	None	1-1/32	None	None
438-166	C13231	1-1/4 x 1/2	1-5/16	None	None	1-3/4	None	None	1-1/8	None	None
438-167	C13233	1-1/4 x 3/4	1-5/16	None	None	1-3/4	None	None	1-1/8	None	None
438-168	C13235	1-1/4 x 1	1-5/16	None	None	1-3/4	None	None	1-1/8	None	None
438-209	C16231	1-1/2 x 1/2	1-1/2	None	None	1-31/32	None	None	1-5/16	None	None
438-210	C16233	1-1/2 x 3/4	1-1/2	None	None	1-31/32	None	None	1-5/16	None	None
438-211	C16235	1-1/2 x 1	1-1/2	None	None	1-31/32	None	None	1-5/16	None	None
438-212	C16237	1-1/2 x 1-1/4	1-1/2	None	None	1-31/32	None	None	1-5/16	None	None
438-247	C21231	2 x 1/2	1-9/16	None	None	2-7/16	None	None	1-3/8	None	None
438-248	C21233	2 x 3/4	1-9/16	None	None	2-7/16	None	None	1-3/8	None	None
438-249	C21235	2 x 1	1-9/16	None	None	2-7/16	None	None	1-3/8	None	None
438-250	C21237	2 x 1-1/4	1-9/16	None	None	2-7/16	None	None	1-3/8	None	None
438-251	C21239	2 x 1-1/2	1-9/16	None	None	2-7/16	None	None	1-3/8	None	None
438-290	C26233	2-1/2 x 1-1/4	2-15/32	None	None	3-5/16	None	None	2-3/16	None	None
438-291	C26235	2-1/2 x 1-1/2	2-15/32	None	None	3-5/16	None	None	2-3/16	None	None
438-292	C26237	2-1/2 x 2	2-15/32	None	None	3-5/16	None	None	2-3/16	None	None
438-334	C31231	3 x 3/4	2-11/32	None	None	3-9/16	None	None	2-1/16	None	None
438-335	C31233	3 x 1	2-11/32	None	None	3-9/16	None	None	2-1/16	None	None
438-336	C31235	3 x 1-1/4	2-11/32	None	None	3-9/16	None	None	2-1/16	None	None
438-337	C31237	3 x 1-1/2	2-11/32	None	None	3-9/16	None	None	2-1/16	None	None
438-338	C31239	3 x 2	2-11/32	None	None	3-9/16	None	None	2-1/16	None	None
438-339	C31241	3 x 2-1/2	2-11/32	None	None	3-9/16	None	None	2-1/16	None	None
438-420	C41237	4 x 2	2-15/32	None	None	4-9/16	None	None	2-3/16	None	None
438-421	C41239	4 x 2-1/2	2-15/32	None	None	4-9/16	None	None	2-3/16	None	None
438-422	C41241	4 x 3	2-15/32	None	None	4-9/16	None	None	2-3/16	None	None
438-490	C51231	5 x 4	3-15/32	None	None	6-13/32	None	None	3-11/32	None	None
438-532	C61231	6 x 4	3-15/32	None	None	6-11/16	None	None	3-1/32	None	None

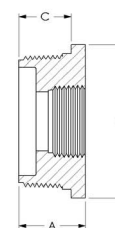
REDUCING BUSHING
 MPT x Reducing FPT

UNIV.#	PART#	SIZE	A	B	C	D	E	F	G	H	J
439-101	C09222	3/4 x 1/2	31/32	None	3/4	1-1/8	None	None	None	None	None
439-130	C11222	1 x 1/2	1-3/32	None	7/8	1-3/8	None	None	None	None	None
439-131	C11223	1 x 3/4	1-3/32	None	7/8	1-3/8	None	None	None	None	None
439-166	C13220	1-1/4 x 1/2	1-3/16	None	7/8	1-3/4	None	None	None	None	None
439-167	C13221	1-1/4 x 3/4	1-3/16	None	7/8	1-23/32	None	None	None	None	None
439-168	C13222	1-1/4 x 1	1-3/16	None	7/8	1-31/32	None	None	None	None	None
439-209	C16220	1-1/2 x 1/2	1-3/16	None	7/8	1-31/32	None	None	None	None	None
439-210	C16221	1-1/2 x 3/4	1-3/16	None	7/8	1-31/32	None	None	None	None	None



REDUCING BUSHING

MPT x Reducing FPT (continued)

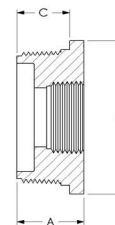

UNIV.#	PART#	SIZE	A	B	C	D	E	F	G	H	J
439-211	C16222	1-1/2 x 1	1-3/16	None	7/8	1-31/32	None	None	None	None	None
439-212	C16223	1-1/2 x 1-1/4	1-3/16	None	7/8	1-31/32	None	None	None	None	None
439-249	C21222	2 x 1	1-3/16	None	7/8	2-3/8	None	None	None	None	None
439-250	C21223	2 x 1-1/4	1-3/16	None	7/8	2-3/8	None	None	None	None	None
439-251	C21224	2 x 1-1/2	1-3/16	None	7/8	2-3/8	None	None	None	None	None
439-292	C26223	2-1/2 x 2	2-15/32	None	2-1/4	3-5/16	None	None	None	None	None
439-338	C31220	3 x 2	2-5/8	None	2-3/8	4	None	None	None	None	None
439-339	C31221	3 x 2-1/2	2-5/8	None	2-3/8	4	None	None	None	None	None
439-422	C41220	4 x 3	2-1/2	None	2-1/4	4-17/32	None	None	None	None	None

CAP*
Soc

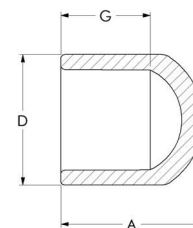

UNIV.#	PART#	SIZE	A	B	C	D	E	F	G	H	J
447-005	C06260	1/2	1-3/16	None	None	1-3/32	None	None	3/4	None	None
447-007	C09260	3/4	1-9/32	None	None	1-5/16	None	None	13/16	None	None
447-010	C11260	1	1-5/8	None	None	1-5/8	None	None	1-1/8	None	None
447-012	C13260	1-1/4	1-3/4	None	None	2	None	None	1-1/4	None	None
447-015	C16260	1-1/2	1-13/16	None	None	2-1/4	None	None	1-7/16	None	None
447-020	C21260	2	2-3/16	None	None	2-3/4	None	None	1-15/32	None	None
447-025	C26260	2-1/2	3-5/16	None	None	2-11/32	None	None	2-5/16	None	None
447-030	C31260	3	3-11/32	None	None	3-31/32	None	None	2-9/32	None	None
447-040	C41260	4	3-21/32	None	None	5-1/32	None	None	2-3/16	None	None
447-050	C51260	5	4-11/16	None	None	6-5/32	None	None	3-3/32	None	None
447-060	C61260	6	5-11/16	None	None	7-3/8	None	None	3-1/16	None	None
447-080	C81260	8	6-21/32	None	None	9-5/16	None	None	4-1/2	None	None

* Note: If using for water filter assembly, contact customer service for pertinent information.

CAP*
FPT

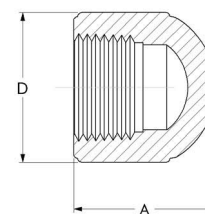

UNIV.#	PART#	SIZE	A	B	C	D	E	F	G	H	J
448-005	C06261	1/2	1-1/16	None	None	1-3/32	None	None	None	None	None
448-007	C09261	3/4	1-1/8	None	None	1-5/16	None	None	None	None	None
448-010	C11261	1	1-9/32	None	None	1-19/32	None	None	None	None	None

CAP*

FPT (continued)

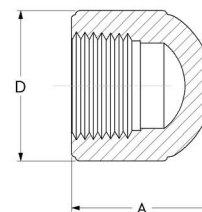

UNIV.#	PART#	SIZE	A	B	C	D	E	F	G	H	J
448-012	C13261	1-1/4	1-19/32	None	None	2	None	None	None	None	None
448-015	C16261	1-1/2	1-19/32	None	None	2-1/4	None	None	None	None	None
448-020	C21261	2	1-7/8	None	None	2-3/4	None	None	None	None	None
448-025	C26261	2-1/2	3-9/32	None	None	3-5/16	None	None	None	None	None
448-030	C31261	3	2-11/16	None	None	4	None	None	None	None	None
448-040	C41261	4	2-15/16	None	None	5-1/32	None	None	None	None	None
448-060	C61261	6	3-1/8	None	None	7-3/16	None	None	None	None	None

* Note: If using for water filter assembly, contact customer service for pertinent information.

PLUG

Spigot

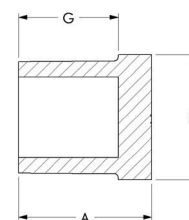

UNIV.#	PART#	SIZE	A	B	C	D	E	F	G	H	J
449-005	C06255	1/2	1-1/16	None	None	15/16	None	None	27/32	None	None
449-007	C09255	3/4	1-1/16	None	None	1-1/8	None	None	27/32	None	None
449-010	C11255	1	1-5/16	None	None	1-3/8	None	None	1-1/16	None	None
449-012	C13255	1-1/4	1-15/32	None	None	1-3/4	None	None	1-7/32	None	None
449-015	C16255	1-1/2	1-21/32	None	None	2	None	None	1-11/32	None	None
449-020	C21255	2	1-3/4	None	None	2-7/16	None	None	1-15/32	None	None
449-030	C31255	3	2-5/8	None	None	4-1/32	None	None	2-3/8	None	None
449-040	C41255	4	2-3/4	None	None	4-15/16	None	None	2-5/16	None	None

PLUG

MPT

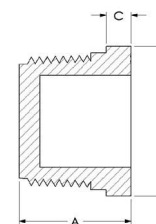

UNIV.#	PART#	SIZE	A	B	C	D	E	F	G	H	J
450-005	C06251	1/2	31/32	None	3/16	15/16	None	None	None	None	None
450-007	C09251	3/4	31/32	None	1/4	1-1/8	None	None	None	None	None
450-010	C11251	1	1-1/8	None	1/4	1-3/8	None	None	None	None	None
450-012	C13251	1-1/4	1-3/16	None	5/16	1-3/4	None	None	None	None	None
450-015	C16251	1-1/2	1-3/16	None	5/16	1-31/32	None	None	None	None	None
450-020	C21251	2	1-3/16	None	9/32	2-13/32	None	None	None	None	None
450-025	C26251	2-1/2	2-15/32	None	1/4	3-5/16	None	None	None	None	None
450-030	C31251	3	2-5/8	None	1/4	4	None	None	None	None	None
450-040	C41251	4	2-13/16	None	9/32	4-31/32	None	None	None	None	None

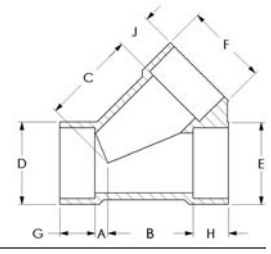

WYE*
Soc x Soc x Soc

UNIV.#	PART#	SIZE	A	B	C	D	E	F	G	H	J
475-020	475-020	2	5/8	3-3/16	3-3/16	2-13/16	2-13/16	2-13/16	1-1/2	1-1/2	1-1/2
475-030	475-030	3	13/16	4-11/32	4-3/4	4-7/32	4-7/32	4-7/32	1-1/2	1-1/2	1-1/2
475-040	475-040	4	27/32	5-3/8	8-3/16	5-7/32	5-7/32	5-7/32	2-9/32	2-9/32	2-9/32
475-060	475-060	6	1-11/32	8-5/8	7-31/32	7-9/16	7-9/16	7-9/16	3-1/32	3-1/32	3-1/32
475-532	475-532	6 x 6 x 4	1-11/32	6-11/16	7	7-5/8	5-3/8	5-3/8	3	3	3

*Maximum system design pressure for WYE fittings at 73 degrees F:

2" 235 psi
 3" 150 psi
 4" 125 psi
 6" 125 psi
 6" x 6" x 4" 150 psi

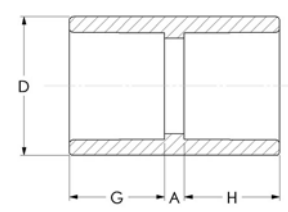

COUPLING-NESTING*
Spigot x Soc

UNIV.#	PART#	SIZE	A	B	C	D	E	F	G	H	J
477-005	C06142	1/2	3/4	None	None	27/32	None	None	3/4	3/4	None
477-007	C09142	3/4	25/32	None	None	1-1/32	None	None	25/32	25/32	None
477-010	C11142	1	31/32	None	None	1-5/16	None	None	15/16	15/16	None
477-012	C13142	1-1/4	1/8	None	None	1-21/32	None	None	1-3/16	1-3/16	None

* Both sides serve as socket or spigot for nesting assembly.

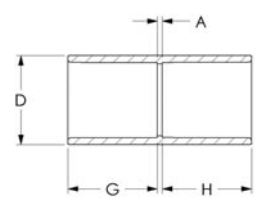

COUPLING-DEEP SOCKET
Deep Soc x Deep Soc

UNIV.#	PART#	SIZE	A	B	C	D	E	F	G	H	J
482-015	C16144	1-1/2	1/8	None	None	2-1/4	None	None	2-1/4	2-1/4	None
482-020	C21144	2	5/32	None	None	2-23/32	None	None	2-7/16	2-3/8	None
482-025	C26144	2-1/2	1/4	None	None	3-5/16	None	None	3-7/8	3-7/8	None
482-030	C31144	3	7/32	None	None	4	None	None	3-3/32	3-3/32	None
482-040	C41144	4	1/4	None	None	5-1/32	None	None	3-3/4	3-11/16	None

UNION

Soc x Soc with EPDM O-ring

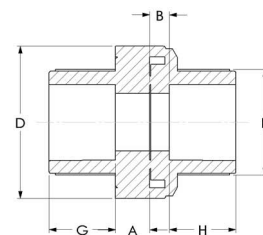

UNIV.#	PART#	SIZE	A	B	C	D	E	F	G	H	J
497-005	497-005	1/2	1/2	1/4	None	1-15/16	1-1/8	None	15/32	3/4	None
497-007	497-007	3/4	1/2	1/4	None	2-3/16	1-11/32	None	1/2	25/32	None
497-010	497-010	1	19/32	5/16	None	2-5/8	1-21/32	None	9/16	15/16	None
497-012	497-012	1-1/4	21/32	11/32	None	3-1/16	2	None	3/4	1-1/8	None
497-015	497-015	1-1/2	21/32	11/32	None	3-3/8	2-1/4	None	15/16	1-5/16	None
497-020	497-020	2	23/32	13/32	None	4	2-3/4	None	31/32	1-3/8	None

UNION

Soc x Soc with Buna O-ring

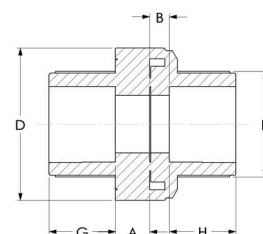

UNIV.#	PART#	SIZE	A	B	C	D	E	F	G	H	J
457-005	457-005	1/2	1/2	1/4	None	1-15/16	1-1/8	None	15/32	3/4	None
457-007	457-007	3/4	1/2	1/4	None	2-3/16	1-11/32	None	1/2	25/32	None
457-010	457-010	1	19/32	5/16	None	2-5/8	1-21/32	None	9/16	15/16	None
457-012	457-012	1-1/4	21/32	11/32	None	3-1/16	2	None	3/4	1-1/8	None
457-015	457-015	1-1/2	21/32	11/32	None	3-3/8	2-1/4	None	15/16	1-5/16	None
457-020	457-020	2	23/32	13/32	None	4	2-3/4	None	31/32	1-3/8	None

BRASS END PIECE FOR SCH 40 UNIONS

FPT

PART#	SIZE	
C06284BR	1/2	For proper transition from metal to plastic. Order appropriately sized union separately. Please refer to page 32 (Method 4) for details on transition installations.
C09284BR	3/4	
C11284BR	1	
C13284BR	1-1/4	
C16284BR	1-1/2	
C21284BR	2	

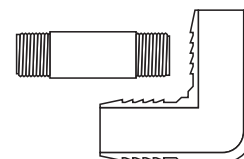
PVC INSERT FITTINGS
PVC AND CPVC THREADED PIPE NIPPLES

Colonial Engineering also offers PVC Insert Fittings for use with flexible polyethylene pipe and Threaded Pipe Nipples in PVC and CPVC. See our list price sheets for more information.



PVC SCHEDULE 40 FITTINGS